

H-64-668

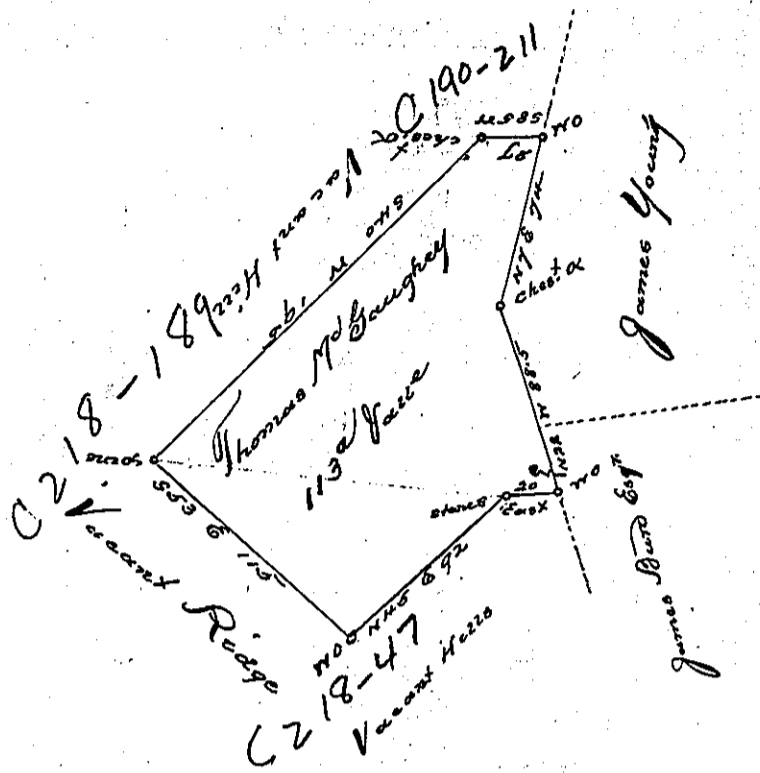

Situated on the Northern End of side of the Long Ridge including a small spring which empties into the Ray's Town Branch of Juniata in the Township and County of Bedford and Surveyed the 18<sup>th</sup> day of December 1787. In pursuance of a warrant dated the 26<sup>th</sup> day of November 1787.

Taken from the field notes of George Woods late Deputy Surveyor of Bedford County November 18<sup>th</sup> 1792.

George Woods Junr. D.S.

To Daniel Brodhead Esq.  
D.S.

IN TESTIMONY that the above is a copy of the original remaining on file in the Department of Internal Affairs of Pennsylvania, made conformably to an Act of Assembly approved the 16th day of February, 1833, I have hereunto set my Hand and caused the Seal of said Department to be affixed at Harrisburg, this fifth day of April 1898

James W. Latta  
Secretary of Internal Affairs.